

CONTAINER WASHING EQUIPMENT

REAR LOADING. HOT WATER



The rear-loading container washing equipment in hot water cleans the bins and containers inside and outside by means of rotating heads and fix bar with nozzles that spray water at high pressure. The container washer is compatible with bins ranging from 80 to 390 liters, flat cover containers with capacities from 500 to 1200 liters and 770 to 1300 liters containers.

PUMP PERFORMANCE

(50 l/min 150 bares).

DRIVE

Hydrostatic transmission.

FINISHING

Interior: protection with a special epoxy-resin treatment.

Exterior: primer coat and high quality white polyurethane finish according to RAL cabin.

GAS ADAPTED CHASSIS

For hot water equipment, incompatibility with gas cylinders on the frame.



WASHING EQUIPMENT

	Hot water
Alternative operating heads	Standard
15 meter hose reel and spray gun	Optional
Descaler	Optional
Detergent dosage equipment	Optional

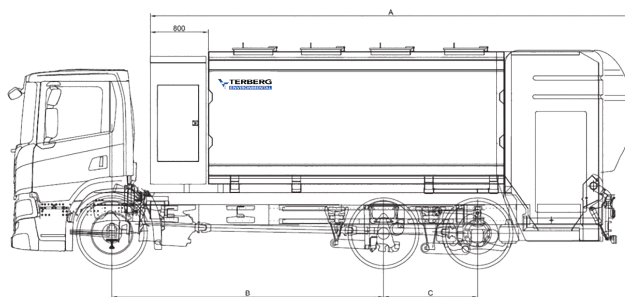
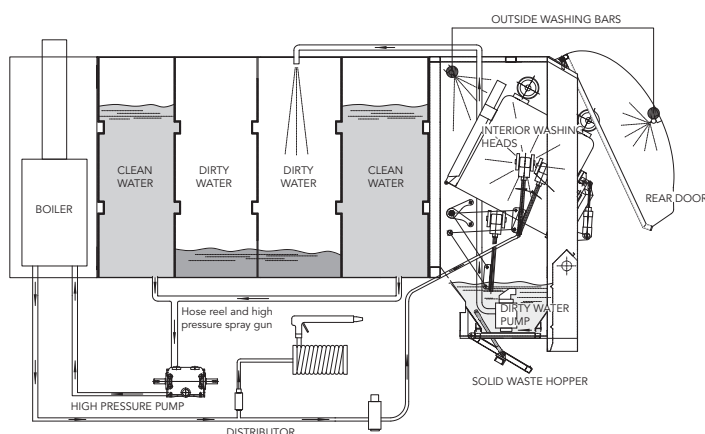

MATERIALS

	Hot water
Tank	Carbon Steel Stainless steel (optional)
Hopper	Stainless steel
Lifter	Stainless steel

VOLUMES AND DIMENSIONS

Capacity	G.M.W.	A	B	C
5.500 liters	16	5.561	3.400 / 3.700	-
6.000 liters	16	5.561	3.400 / 3.700	-
7.000 liters	18	6.374	3.900 / 4.200	-
8.000 liters	18	6.885	3.700 / 4.100	1.350

Certifications

- Compliance with European standard EN1501-1 and EN1501-5.
- Compliance with Directive 2006/42/EC on machinery safety.
- Compliance with European standard 2000/14/EC on noise emission.
- Certificate of hydraulic fluid cleanliness in accordance with ISO 4406.
- ISO 9001, ISO 14001, EMAS III, ISO 45001, ISO 50001, ISO 14006 and ISO 14064-1.



TERBERG ENVIRONMENTAL

Postbus 202, 3400AE. IJsselstein, The Netherlands

T +31 (0) 30 68 68 700, E sales@terbergenvironmental.com, I www.terbergenvironmental.com

We reserve the right to carry out technical modifications. Modification of specifications may be carried out without prior notice. Illustrations may not necessarily depict current equipment versions.