



Olympus Mini Service Manual

CONTENTS		PAGE
3	Daily checks.....	3-3
3.1	Daily safety checks - refuse collection body.....	3-3
3.2	Daily safety checks - waste container lifting device (when fitted).....	3-22
3.3	Daily safety checks - footboard (when fitted)	3-24
3.4	Daily safety check - safety light curtain (when fitted).....	3-26
3.5	Warning labels.....	3-28
3.6	Explanation of pictorial warning labels	3-30



DAILY CHECKS

This page intentionally left blank



3 Daily checks

It is important that your machine is kept in good working order.

The following daily safety checks must be carried out on an Olympus Mini Refuse Collection Vehicle to confirm the correct operation of the machine, its controls, safety circuits and interlocks, in addition to checks specified in the chassis-cab manufacturer's and any ancillary equipment manufacturer's service information, before it commences service.

The same checks should also be carried out by service personnel whenever scheduled maintenance service procedures and inspections are carried out or if a major repair is made to the bodywork or its operating systems.

Make sure that there is no mechanical damage or wear evident in the refuse mechanism, especially in the pivoting and locking of the tailgate to the body.

Any problems must be reported to supervision immediately.

3.1 Daily safety checks - refuse collection body

1. Stand the vehicle on clean, level and stable ground with sufficient clearance to allow for the tailgate and waste container lifting device, if fitted, to be fully raised.
2. Engage the parking brakes.
3. Select Neutral 'N'.
4. Stop the engine.
5. Turn the 'Body main' switch to the 'off' position. Remove and retain the key.



6. Switch the ignition 'off'. Remove and retain the key.
7. Lock all cab doors. Remove and retain the keys.
8. Walk around the Refuse Collection Vehicle and:
 - Make sure that there is no refuse, paper or flammable materials near the engine or exhaust. These could cause a fire when the engine is started. If necessary, tilt the cab (see Chassis-cab Manufacturer's Operator's Handbook) to make a thorough inspection.

- Visually check level of oil in hydraulic oil tank. The float in the bottom sight glass should be at the top of the sight glass. If the level is below this report to supervision immediately and do not proceed any further with the daily inspection.



4640-OM1-R-GB-G1

- Visually check for obvious damage to lamps, warning beacons, reflectors and lenses and bodywork.
 - Check that all marking plates and warning instruction labels are complete, clean, clearly visible and readable (see '3.5 Warning labels' on page 3-28).
 - Visually check underneath (BUT DO NOT GO UNDERNEATH THE VEHICLE) the Refuse Collection Vehicle for evidence of hydraulic oil leaks from the body system hydraulic pipes.
 - Visually check the electrical harnesses and connections, hoses, pipes and other components for obvious signs of defects.
9. Arrange for an assistant to observe the operation of body systems and lamps from a safe viewpoint at the rear of the vehicle.
 10. Enter the Refuse Collection Vehicle cab.
 11. Check that all the emergency tools, equipment and fire extinguisher are present.
 12. Check that the first aid kit is complete.



DAILY CHECKS

3

- Switch the ignition 'on' only, do not start the engine.
 - The control screen should initialise and then display the 'Body system off' mode.

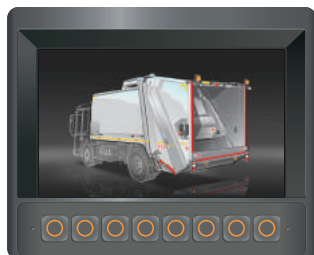

4713-OM1-R-GB-G1

- Switch on all the vehicle lamps, including fog lamps (if fitted).
 - Check that the lamps and their associated warning lamps illuminate when switched 'on' and extinguish when switched 'off'.
- Operate the footbrake.
 - Check that all the brake lamps illuminate when the pedal is pressed and extinguish when the pedal is released.

- Switch on the warning beacons.
 - Check that the warning beacons and their associated warning lamps operate correctly when switched 'on' and extinguish when switched 'off'.
 - If separate cab beacon switch is fitted check that it over-rides function on cab control panel.

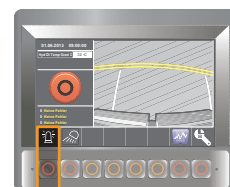
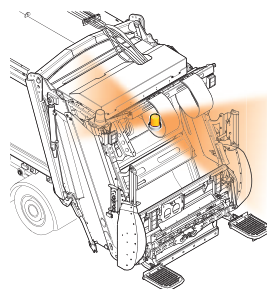

4642-OM1-R-GB-G1

- Make sure that the parking brake is applied and Neutral 'N' is selected.
- Engage the PTO (see chassis cab manufacturer's operating instructions).
- Start and run the engine.
- Check the warning panels and instrumentation for any indications of system malfunctions.
 - The 'Low air pressure' warning buzzers should not be sounding.
- Turn the 'Body main' switch 'on'.



- The screen should display the 'Body system run' mode and 'System on' pictogram.



2748-DS003-OL1-D-GB-G2

- If any warning pictograms are displayed on the screen, report to supervision immediately and do not proceed any further with the daily inspection.



22. Press and release the 'Work lamp' switch.

- Check that the tailgate loading lamps and all the work lamps fitted to the vehicle illuminate.

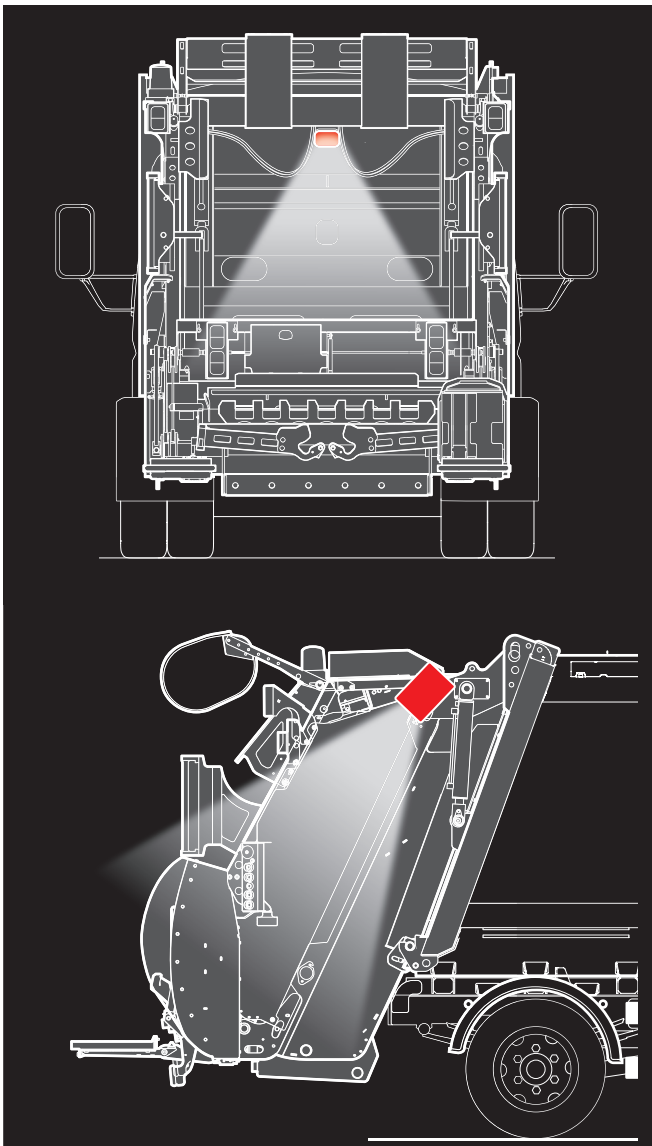

4643-OM1-R-GB-G1

23. Press and release the 'Internal discharge controls' switch.

- The screen should display the 'Body discharge internal controls' mode.



2748-DS028-OL1-D-GB-G2

24. Check that 'Tailgate clear' pictogram is white, then press and release the switch below it one or more times so that the pictogram changes colour to green and a white number from 1 to 4 appears in the pictogram.

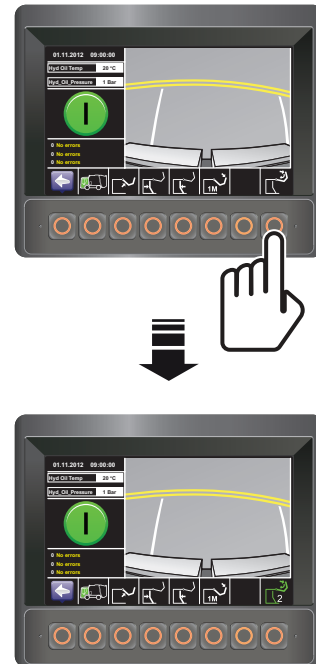

2748-DS046-OL1-D-GB-G1



WARNING:
MAKE SURE THAT YOU KNOW THE HEIGHT OF YOUR VEHICLE WITH THE TAILGATE AND WASTE CONTAINER LIFTING DEVICE, IF FITTED, RAISED.



DAILY CHECKS

3

25. Press and hold the 'Tailgate raise' switch until the tailgate is just out of its locks and then release the switch.

- Tailgate should raise smoothly until it is out of the locks.
- 'Vehicle reversing' alarm should sound immediately the tailgate is out of the locks while the 'Tailgate raise' is being pressed and the tailgate is rising.

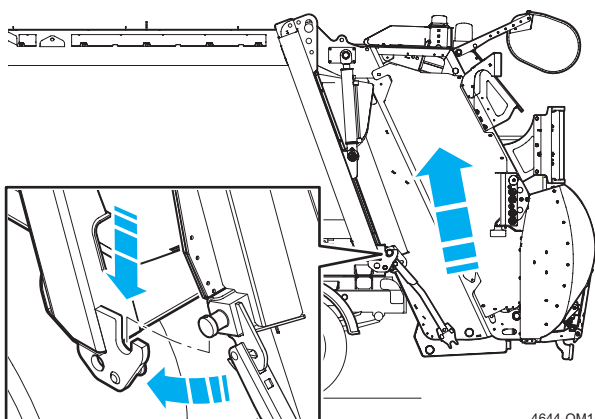

4644-OM1-R-GB-G1

- 'Tailgate out-of-locks' pictogram should display on the control panel screen when the 'Tailgate raise' switch is released.



WARNINGS:
MAKE SURE THAT YOU KNOW THE HEIGHT OF YOUR VEHICLE WITH THE TAILGATE AND WASTE CONTAINER LIFTING DEVICE, IF FITTED, RAISED.

DRIVER MUST BE IN CAB.

PARKING BRAKE MUST BE APPLIED.

ALL PERSONNEL MUST BE CLEAR OF FRONT AND REAR OF VEHICLE.

VEHICLE MAY LURCH FORWARDS.

26. Firmly apply the footbrake. Then select a gear.

- 'Tailgate out-of-locks' warning buzzer in the cab should sound immediately the gear is selected.

27. Select Neutral 'N'.

- 'Tailgate out-of-locks' warning buzzer in the cab should silence immediately Neutral 'N' is selected.

28. Press and release the return switch.

- The screen should display the 'Body system run' mode and 'Tailgate out-of-locks' pictogram.



2748-DS047-OL1-D-GB-G3



WARNING:
COMPACTION MECHANISM MAY OPERATE. MAKE SURE THAT THE TAILGATE AREA IS CLEAR OF PERSONNEL.



29. On the compaction mechanism control panel, press in turn the:

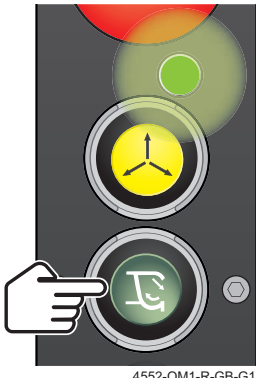

'Start pack cycle' push-button.

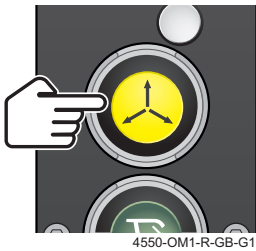

'Rescue' push-button.

31. Press in turn the:



'Start pack cycle' push-button.

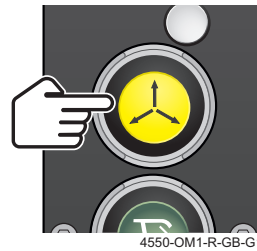

'Rescue' push-button.

30. If the vehicle is fitted with a compaction mechanism control panel on each side, press and release the de-energised 'Start pack cycle' push-button on the opposite control panel to activate it.

- Compaction mechanism should not operate.

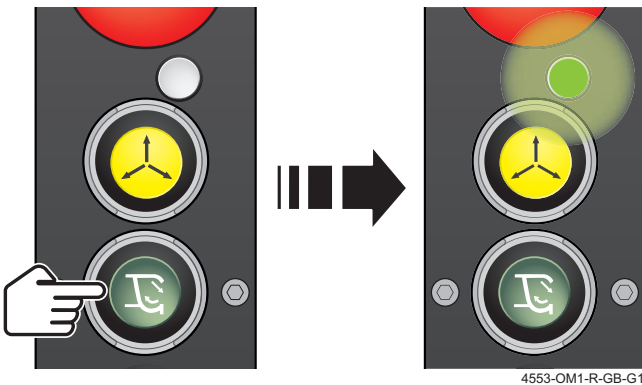

- The green indicator lamp should illuminate.

32. Turn the 'Body main' switch off and then on.
33. Press and release the 'Internal discharge controls' switch.

- The screen should display the 'Body discharge internal controls' mode and 'Tailgate out-of-locks' pictogram.



2748-DS048-OL1-D-GB-G3



WARNING:
COMPACTION MECHANISM MAY OPERATE.
MAKE SURE THAT THE TAILGATE AREA IS CLEAR OF PERSONNEL.



DAILY CHECKS

34. On each compaction mechanism control panel, press in turn the:

3

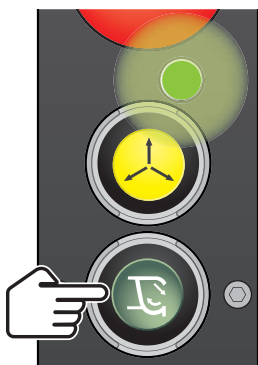

4552-OM1-R-GB-G1

'Start pack cycle' push-button.



4550-OM1-R-GB-G1

'Rescue' push-button.

- Compaction mechanism should not operate.



WARNING:
MAKE SURE THAT YOU KNOW THE HEIGHT OF YOUR VEHICLE WITH THE TAILGATE AND WASTE CONTAINER LIFTING DEVICE, IF FITTED, RAISED.

35. Press and hold the 'Tailgate raise' switch.

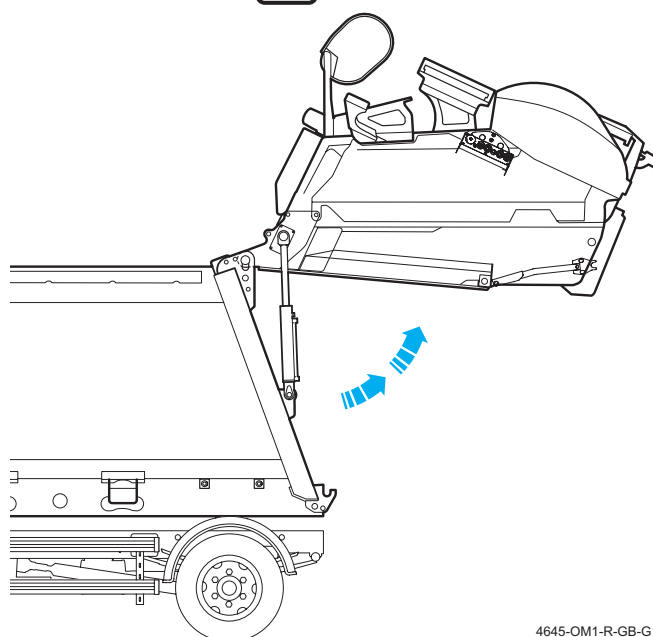

4645-OM1-R-GB-G1

- Tailgate should rotate smoothly upwards about the hinge pins.
- 'Vehicle reversing' alarm should sound.

36. While tailgate is rising, release the switch before it reaches its fully raised position.

- Tailgate should stop rising immediately the switch is released.
- Tailgate should not lower.
- 'Tailgate out-of-locks' pictogram should display on the control panel screen.



2748-DS049-OL1-D-GB-G2

- 'Vehicle reversing' alarm should silence.



37. Press and hold the 'Tailgate raise' switch until the tailgate is fully raised and then release the switch.

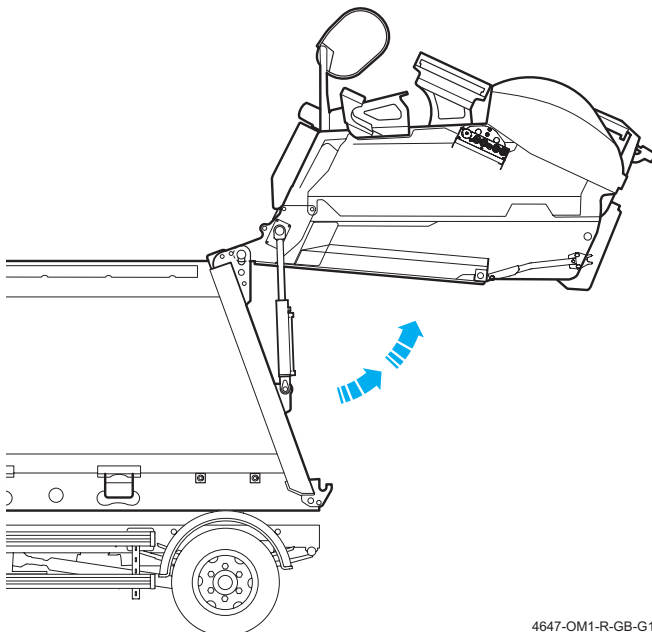

- Tailgate should resume rotating upwards about the hinge pins until fully raised when it should stop without noticeable judder.
- 'Vehicle reversing' alarm should sound while the 'Tailgate raise' switch is being pressed and the tailgate is rising.
- When the tailgate is raised, the 'Tailgate fully raised' pictogram should display on the control panel screen.

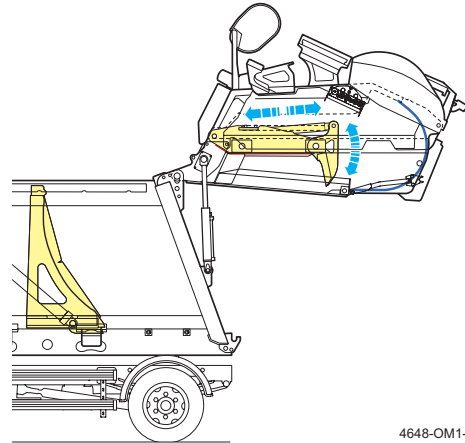

- Immediately the tailgate reaches full height, the compaction mechanism should complete the number of full cycles shown by the white number in the tip clear pictogram, i.e. packer plate open, carriage plate down, packer plate close and then carriage plate up, in one continuous sequence until fully packed when it should stop.



WARNINGS:
MAKE SURE THAT YOU KNOW THE HEIGHT OF YOUR VEHICLE WITH THE TAILGATE AND WASTE CONTAINER LIFTING DEVICE, IF FITTED, RAISED.

DRIVER MUST BE IN CAB.

PARKING BRAKE MUST BE APPLIED.

ALL PERSONNEL MUST BE CLEAR OF FRONT AND REAR OF VEHICLE.

VEHICLE MAY LURCH FORWARDS.

38. Firmly apply the footbrake. Then select a gear.
- 'Tailgate out-of-locks' warning buzzer in the cab should sound immediately the gear is selected.
39. Select Neutral 'N'.
- 'Tailgate out-of-locks' warning buzzer in the cab should silence immediately Neutral 'N' is selected.



DAILY CHECKS

40. Press the eject switch. Release the switch when the ejection plate has reached the end of its travel.

41. Press the retract switch. Release the switch when the ejection plate has reached the end of its travel.

3

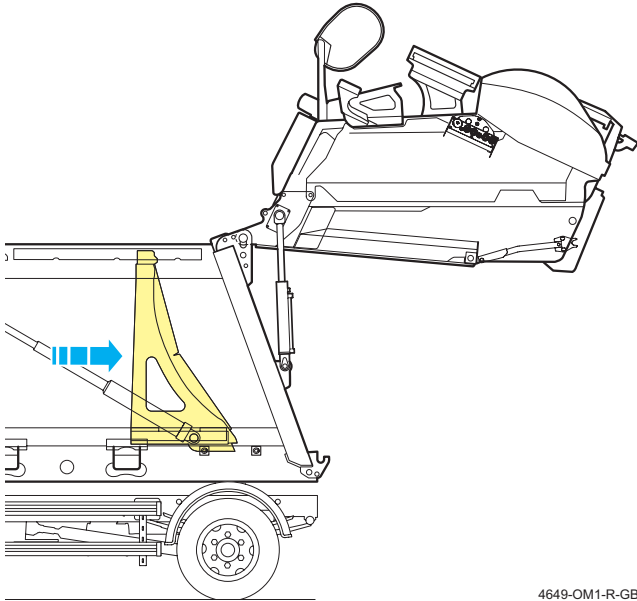

4649-OM1-R-GB-G1

- Ejection plate should eject smoothly without judder.

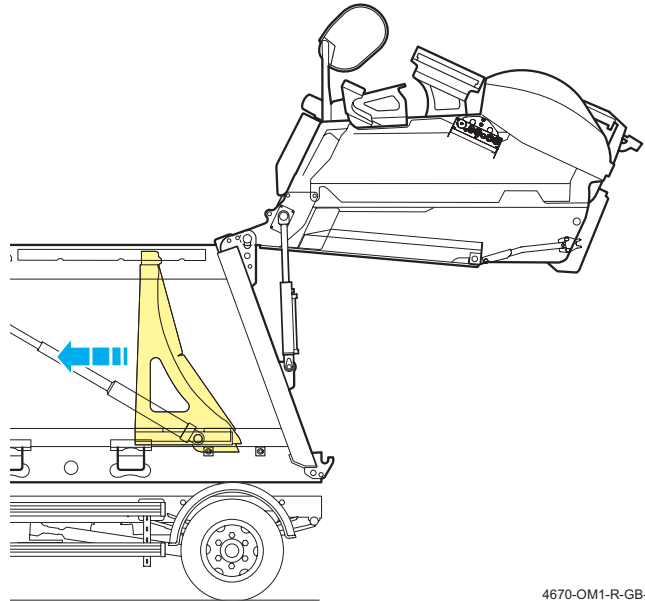

4670-OM1-R-GB-G1

- Ejection plate should retract smoothly without judder.



42. Press the eject switch. Release the switch when the ejection plate has reached the end of its travel.

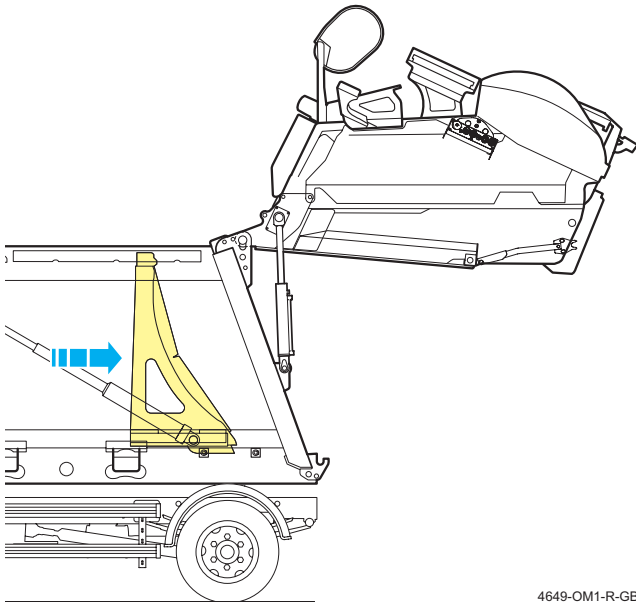

4649-OM1-R-GB-G1

43. Press each of the two push-buttons on the 'Tailgate lowering' control panel separately.

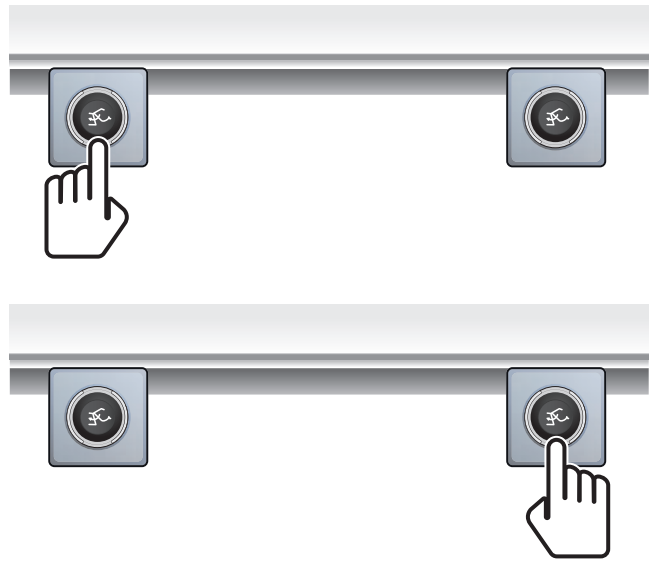

4671-OM1-R-GB-G1

- Tailgate should not lower.



WARNING:
MAKE SURE THAT THE TAILGATE AREA IS CLEAR OF PERSONNEL.



DAILY CHECKS

3

44. Press the two push-buttons on the 'Tailgate lowering' control panel simultaneously.

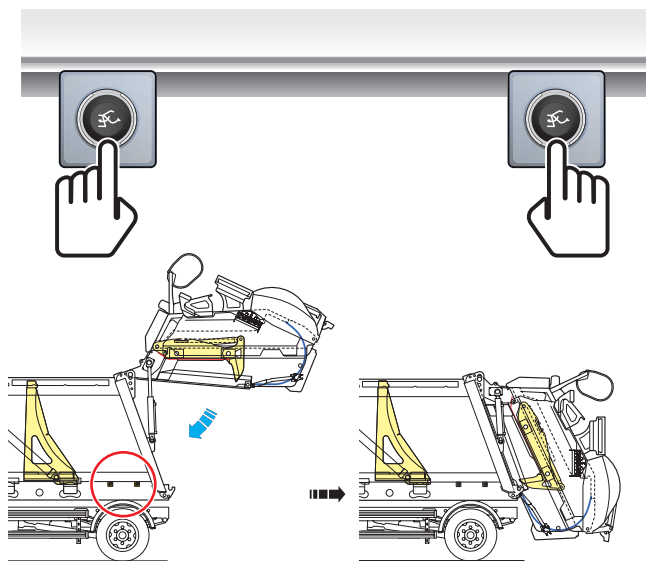

4580-OM1-R-GB-G1

- The engine speed should increase.
- The ejection plate should retract into the body for 1-2 seconds before tailgate starts to lower.
- Tailgate should lower smoothly without judder.
- 'Vehicle reversing' alarm should sound.

45. While tailgate is lowering, release one of the push-buttons but keep the other push-button depressed.

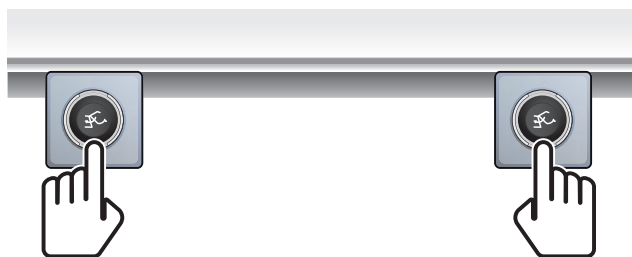

4582-OM1-R-GB-G1

- Tailgate should stop lowering immediately the push-button is released.
- Tailgate should not lower.
- 'Tailgate out-of-locks' pictogram should display on the control panel screen.



- 'Vehicle reversing' alarm should silence.

46. While keeping the push-button depressed, press the released push-button again.

- Tailgate should remain stationary.
- 'Tailgate out-of-locks' pictogram should continue to display on the control panel screen.

Release both push-buttons.

47. Press the two push-buttons on the 'Tailgate lowering' control panel simultaneously until the tailgate engages locks and then release the push-buttons.



4582-OM1-R-GB-G1

- Tailgate should rotate smoothly downwards about the hinge pins until it engages face of body, then lower into locks.
- 'Vehicle reversing' alarm should sound until the tailgate engages locks when it should silence.
- 'System on' pictogram should display when the tailgate engages locks.



2748-DS050-OL1-D-GB-G2

48. Press the 'Tip clear' switch until the pictogram changes colour to white without any number beside it.



2748-DS037-OL1-D-GB-G2



49. Press and hold the 'Tailgate raise' switch until the tailgate is fully raised and then release the switch.

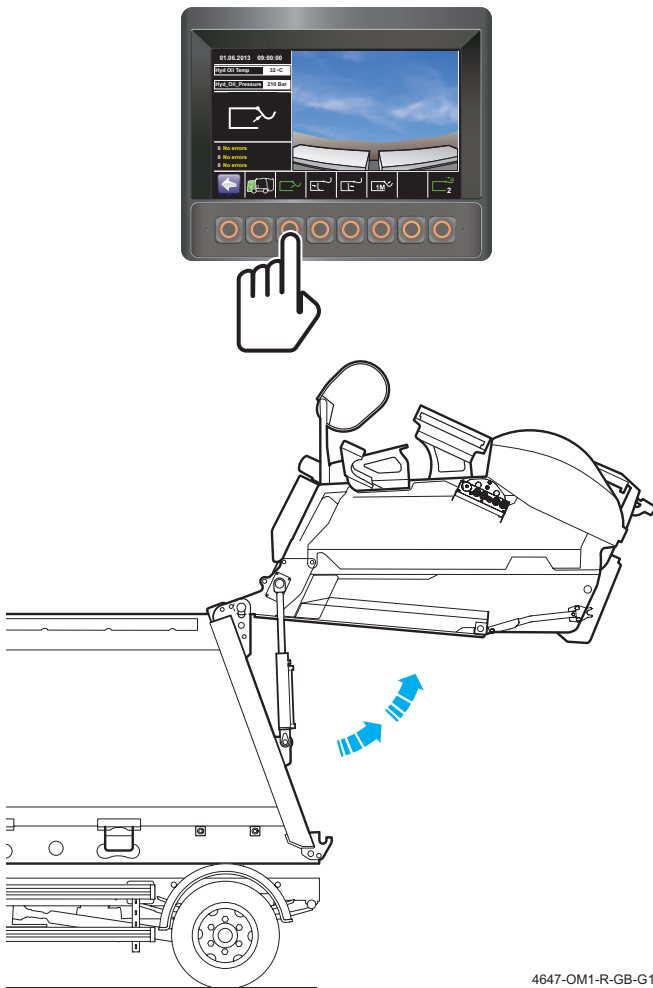

4647-OM1-R-GB-G1

- Tailgate should raise until fully raised when it should stop without noticeable judder.
- 'Vehicle reversing' alarm should sound while tailgate is rising.
- 'Tailgate raised' pictogram should display on the control panel screen.
- Immediately the tailgate reaches full height, the compaction mechanism should not operate.

50. Press and hold the 'Lower tailgate to 1 metre' switch until the tailgate stops lowering and then release the switch.

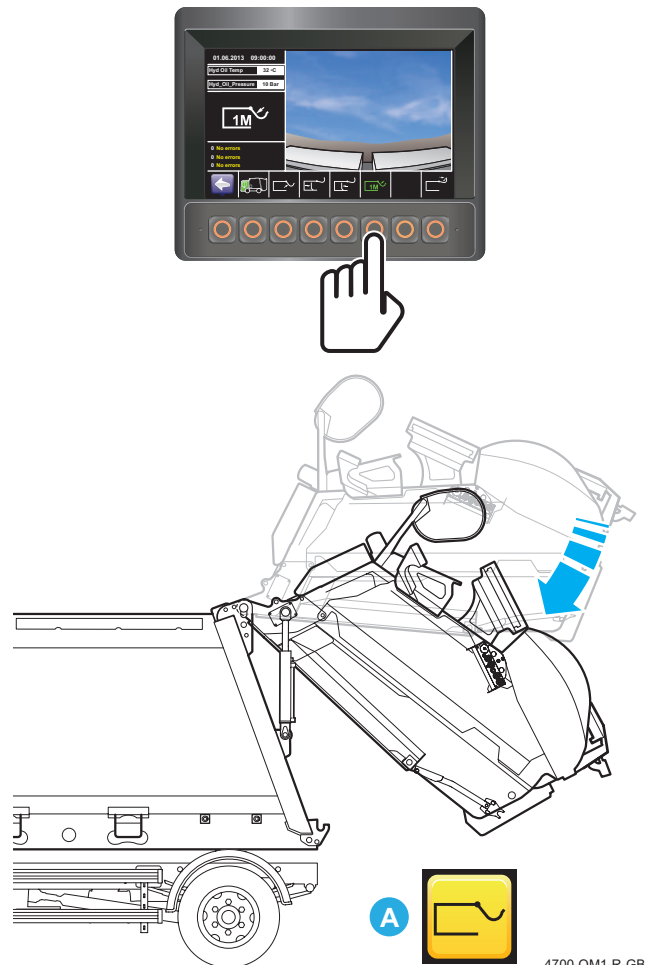

4700-OM1-R-GB-G1

- Tailgate should rotate smoothly downwards about the hinge pins until it is 1 metre from the body when it should stop without noticeable judder.
- 'Vehicle reversing' alarm should sound while tailgate is lowering.
- 'Tailgate out-of-locks' pictogram, A, should display on the control panel screen.



DAILY CHECKS

3

51. Press the two push-buttons on the 'Tailgate lowering' control panel simultaneously until the tailgate engages locks and then release the push-buttons.

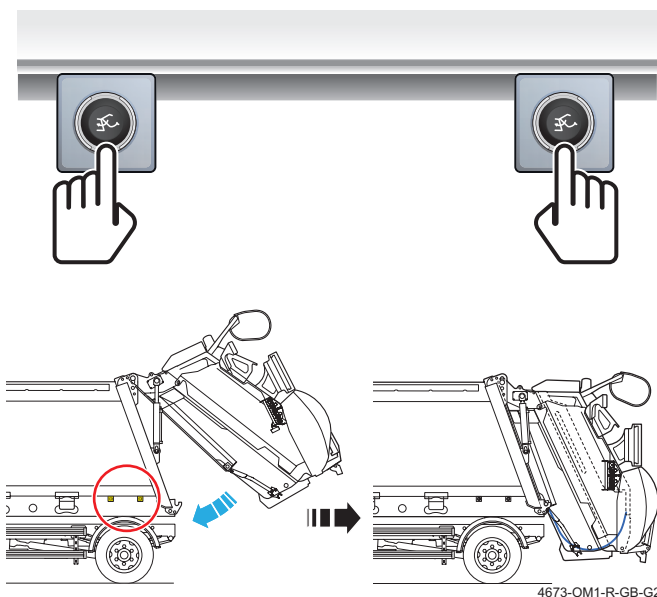

- Tailgate should rotate smoothly downwards about the hinge pins until it engages face of body, then lower into locks.
- 'Vehicle reversing' alarm should sound until the tailgate engages locks when it should silence.
- 'System on' pictogram should display when the tailgate engages locks.



52. Press and release the return switch.

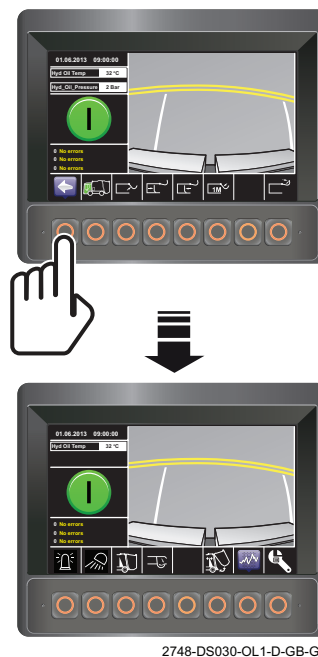

- The screen should display the 'Body system run' mode and 'System on' pictogram.



**WARNINGS:
DRIVER MUST BE IN CAB.**

PARKING BRAKE MUST BE APPLIED.

**ALL PERSONNEL MUST BE CLEAR OF
FRONT AND REAR OF VEHICLE.**

53. Select a gear in the cab.

54. Press 'Start pack cycle' push-button on compaction mechanism control panel.

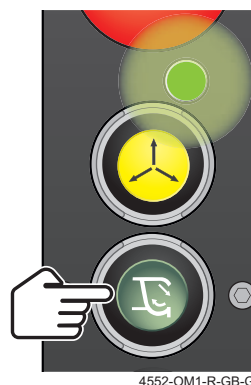

- Compaction mechanism should not operate.

55. Select Neutral.



For each compaction mechanism control panel, carry out the following operations (55 - 61):

56. Check that pack cycle operates correctly according to variant.

Closed system vehicles:

- **Vehicles fitted with a light curtain and folding rave rail in raised position.**
- **Vehicles fitted with a light curtain and fixed (welded) rave rail.**

Energise each 'Start pack cycle' push-button in turn and then press and release the 'Start pack cycle' push-button.

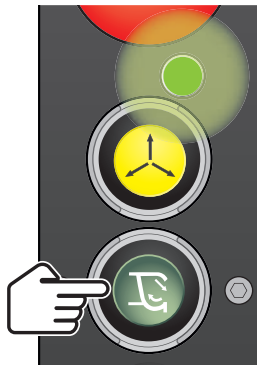

4552-OM1-R-GB-G1

- Green LED below push-button should be illuminated.

- Compaction mechanism packer plate should open (1), carriage plate and packer plate should move downwards (2), packer plate should close (3), carriage plate and packer plate should move upwards (4) and automatically stop in the packed position.

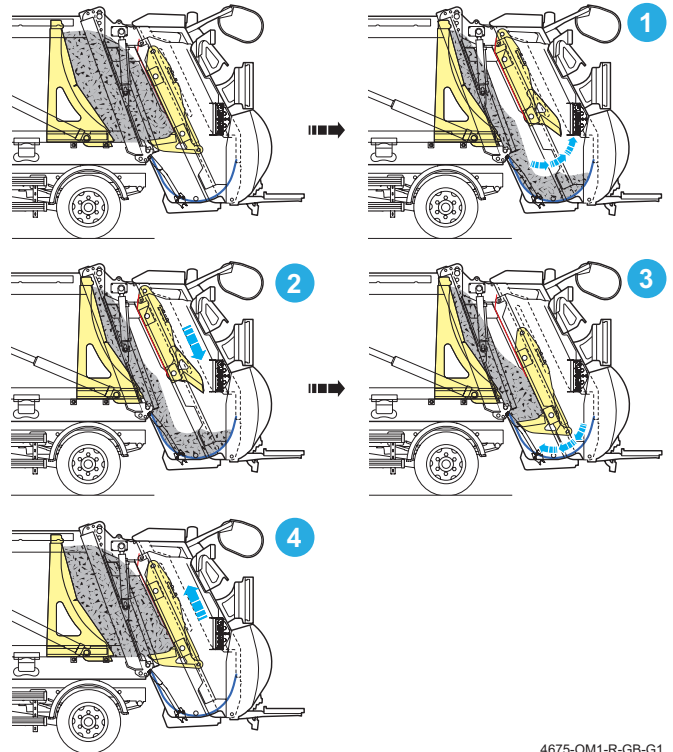

4675-OM1-R-GB-G1



DAILY CHECKS

3

Open system vehicles:

- Vehicles not fitted with light curtain.
- Vehicles fitted with light curtain and folding rave rail in lower position.

57. Press and release the 'Start pack cycle' push-button.

- Packer plate should open and then stop.

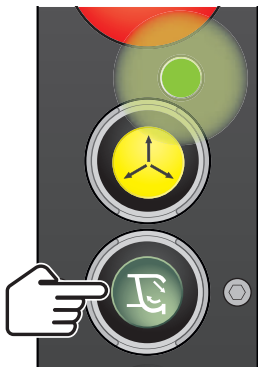

4552-OM1-R-GB-G1

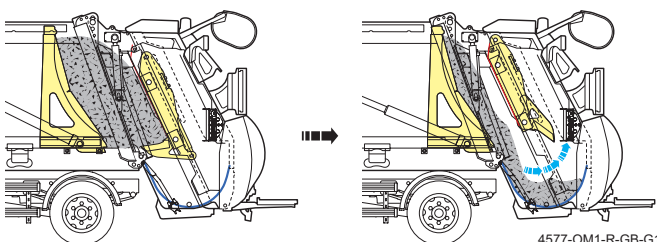

4577-OM1-R-GB-G1

58. Press and hold the 'Start pack cycle' push-button.

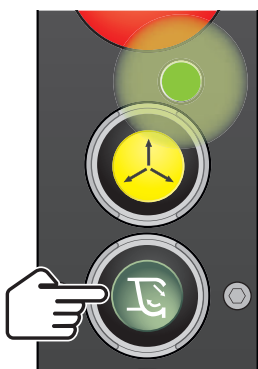

4552-OM1-R-GB-G1

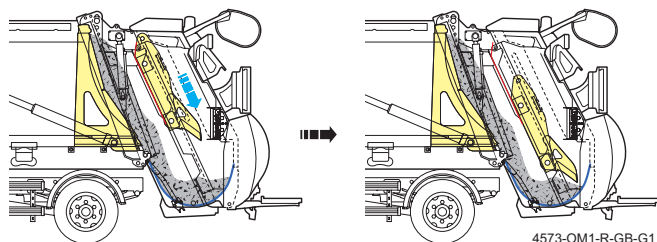

4573-OM1-R-GB-G1

- Carriage plate and packer plate should move downwards.

59. Release the push-button while the carriage plate and packer plate are moving downwards.

- Carriage plate and packer plate should stop immediately.

60. Press and hold the 'Start pack cycle' push-button again.

- Carriage plate and packer plate should continue to move fully downwards from stopped position and then stop when carriage plate fully lowered.

61. Press and hold the 'Start pack cycle' push-button again.

- The packer plate should close.

Release the push-button after the packer plate has started to close.

- Packer plate should automatically close and then the carriage plate and packer plate should move upwards until the compaction mechanism is fully packed when it should stop.

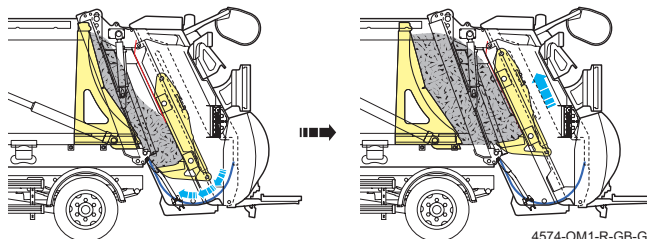

4574-OM1-R-GB-G1

62. Press the 'Signal' push-button.

- 'Tailgate signal' buzzer in the cab should sound immediately the push-button is pressed and silence immediately the push-button is released.



4549-OM1-R-GB-G1

- The 'Signal' warning pictogram should display on the control panel screen while the button is pressed.





For each 'Emergency stop' push-button:

- Cab control panel (x 1)
- Compaction mechanism control panel (x 2)

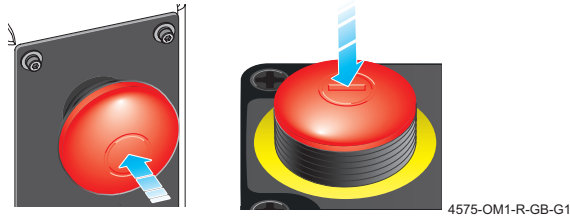

Carry out the following operations (62 - 68):

63. Press a 'Start pack cycle' push-button, to operate the compaction mechanism so that carriage plate is moving upwards.

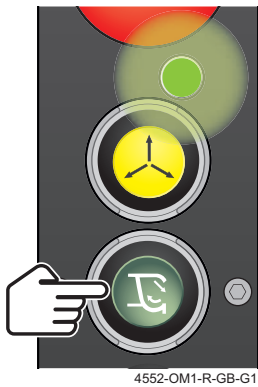

While the carriage plate or packing plate is moving, press the 'Emergency stop' push-button.

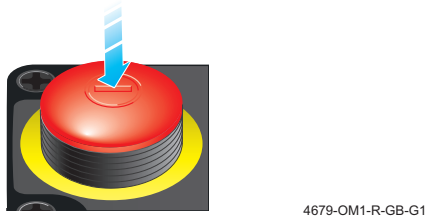

- Compaction mechanism should stop immediately.
- 'Emergency stop' warning buzzer in the cab should sound.
- 'Emergency stop operated' pictogram should display in the control panel screen.



64. On each compaction mechanism control panel, press in turn the:

'Start pack cycle' push-button.

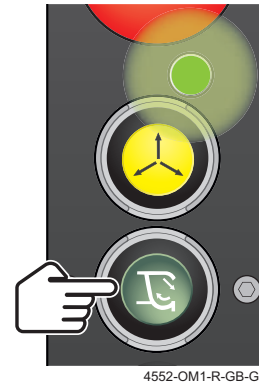

- Compaction mechanism **should not operate.** 'Signal' push-button.

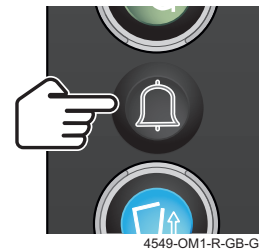

- 'Tailgate signal' buzzer in the cab **should sound.**

'Rescue' push-button.

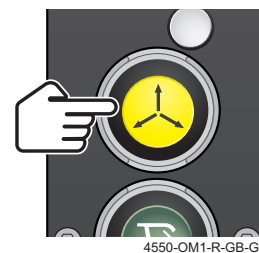



DAILY CHECKS

3

- Packer plate should open and carriage plate move upwards simultaneously until it is fully open and fully unpacked.

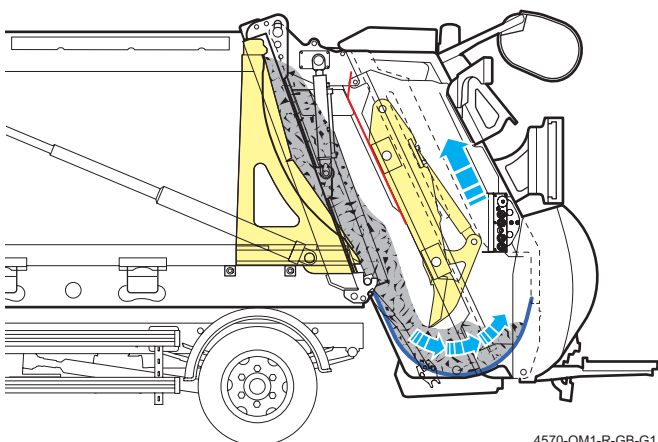

- The 'Rescue' warning pictogram should display on the control panel screen.



65. Turn the 'Body main' switch 'off' and then 'on' again.

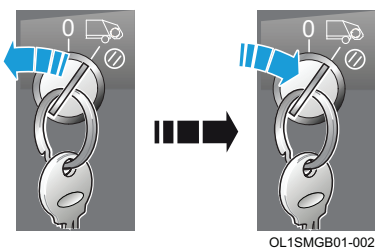

66. Pull the 'Emergency stop' push-button outwards.

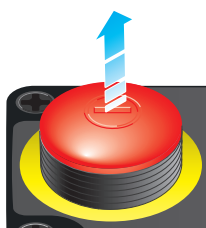

- 'Emergency stop' warning buzzer in the cab should silence.

67. Press the 'Start pack cycle' push-button.



- Compaction mechanism **should not operate.**

68. Turn the 'Body main' switch 'off' and then 'on' again.

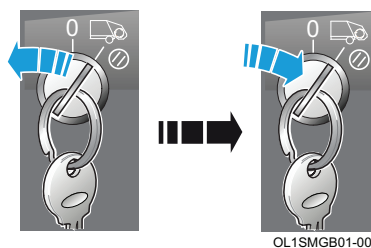

69. Press the 'Start pack cycle' push-button.



- Check that the compaction mechanism restarts and operates to specification.



On vehicles fitted with an external discharge control panel carry out the following operations (69 - 78):

- 70. Press and release the 'Internal discharge controls' switch.
 - The screen should display the 'Body discharge internal controls' mode.



- 71. Press and release the 'External discharge controls' switch.
 - The screen should display the 'Body discharge external controls' mode.



WARNING:
MAKE SURE THAT YOU KNOW THE HEIGHT OF YOUR VEHICLE WITH THE TAILGATE AND WASTE CONTAINER LIFTING DEVICE, IF FITTED, RAISED.

- 72. Press the 'Tailgate raise' push-button.
 - Tailgate should raise smoothly until out-of-locks and then rotate smoothly upwards about the hinge pins.
 - 'Vehicle reversing' alarm should sound immediately the tailgate is out-of-locks and while tailgate is rising.

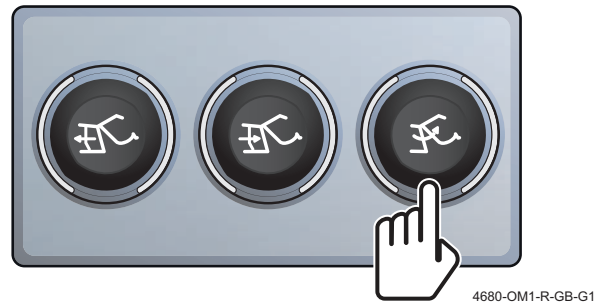
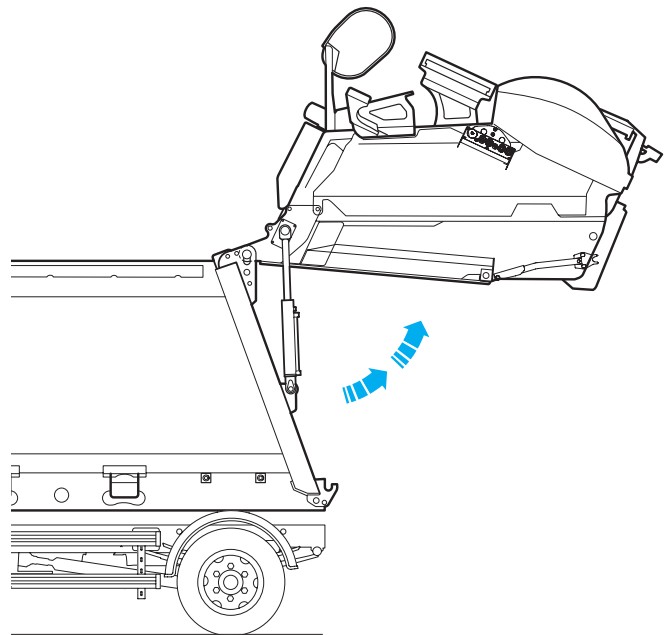

- 'Tailgate out-of-locks' pictogram should display on the control panel screen.





DAILY CHECKS

3

73. While tailgate is rising, release push-button before it reaches its fully raised position.

- Tailgate should stop rising immediately the switch is released.
- Tailgate should not lower.
- 'Tailgate out-of-locks' pictogram should continue to display on the control panel screen.



74. Press the 'Tailgate raise' push-button until the tailgate is fully raised and then release the push-button.

- Check that the tailgate resumes rotating upwards about the hinge pins until fully raised when it should stop without noticeable judder.
- 'Vehicle reversing' alarm should sound while 'Tailgate raise' push-button is pressed and tailgate is rising.

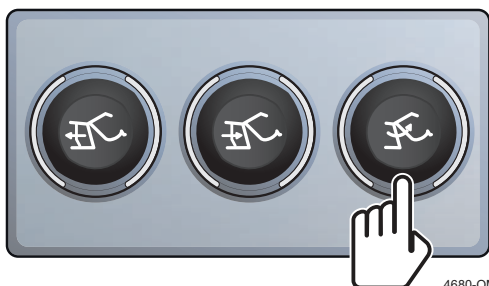
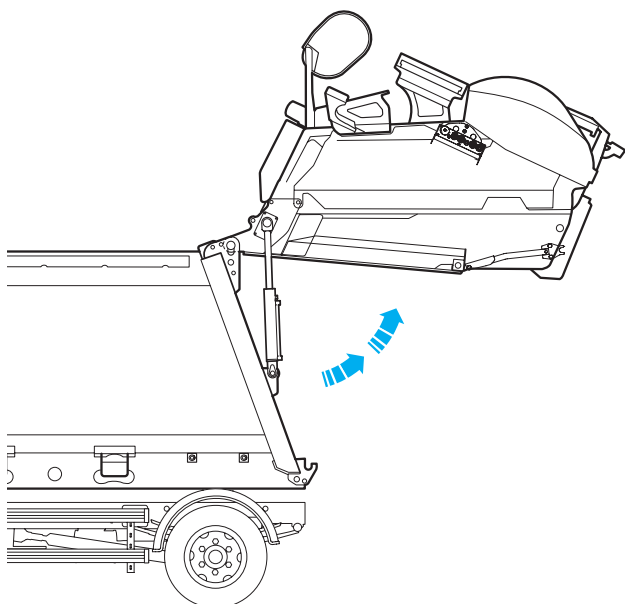

4680-OM1-R-GB-G1

76. Press the 'Ejection plate eject' push-button. Release the push-button when the ejection plate has reached the end of its travel.

- Ejection plate should eject smoothly without judder.

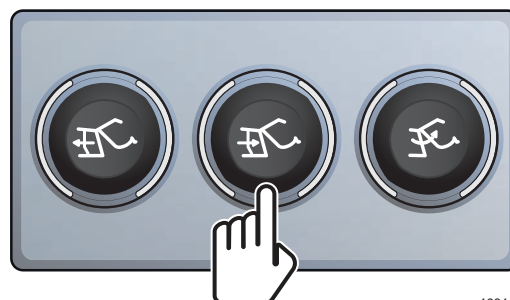
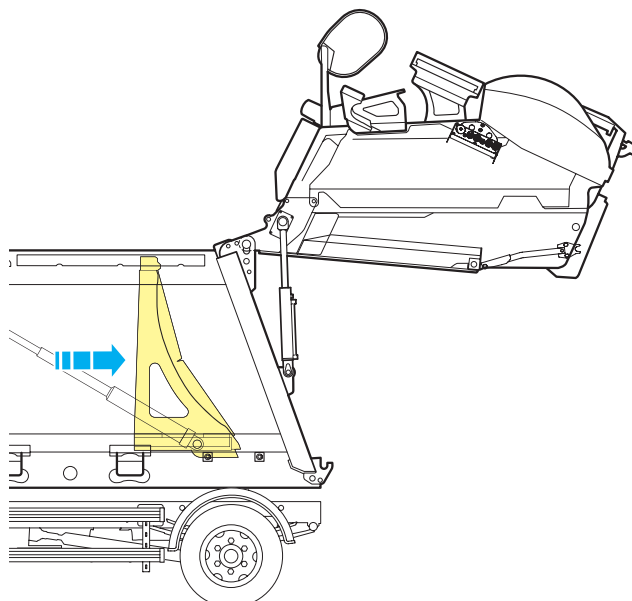

4681-OM1-R-GB-G1

75. When the tailgate is raised, the 'Tailgate fully raised' pictogram should display on the control panel screen.





77. Press the 'Ejection plate retract' push-button.
Release the push-button when the ejection plate has reached the end of its travel.

- Ejection plate should retract smoothly without judder.

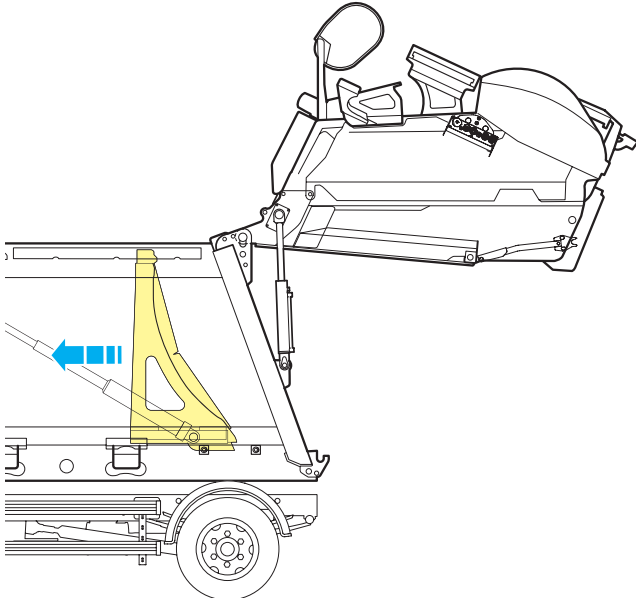

4682-OM1-R-GB-G1

78. Press the 'Ejection plate eject' push-button.
Release the push-button when the ejection plate has reached the end of its travel.

- Ejection plate should eject smoothly without judder.

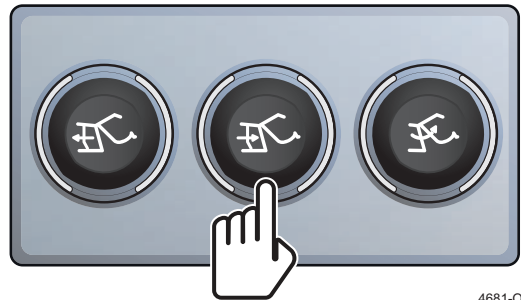
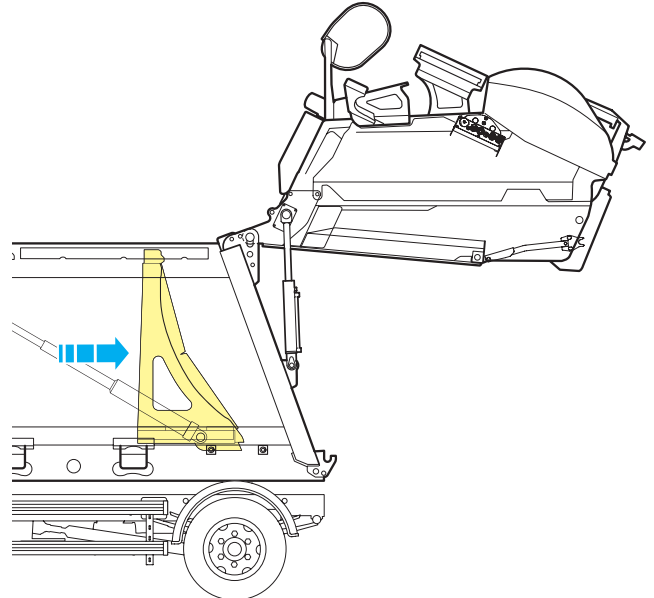

4681-OM1-R-GB-G1



WARNING:
MAKE SURE THAT THE TAILGATE AREA IS
CLEAR OF PERSONNEL.



DAILY CHECKS

79. Press the two push-buttons on the 'Tailgate lowering' control panel simultaneously until the tailgate engages locks and then release the push-buttons.

3

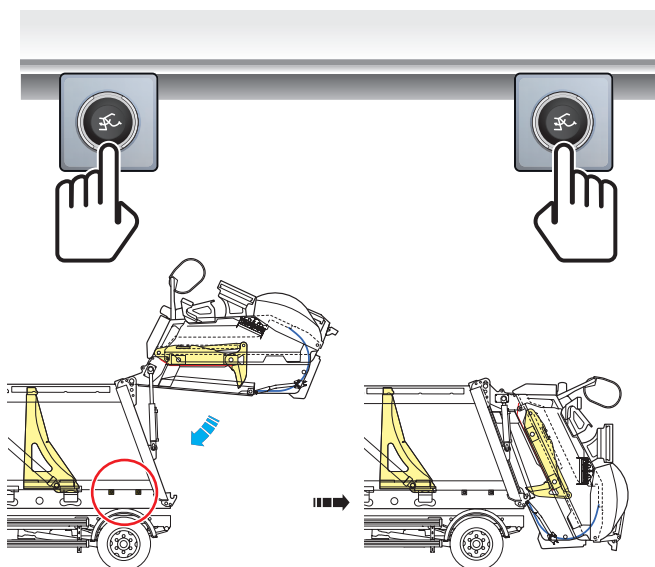

4580-OM1-R-GB-G1

- The engine speed should increase.
- The ejection plate should retract into the body for 1-2 seconds before tailgate starts to lower.
- Tailgate should rotate smoothly downwards about the hinge pins until it engages face of body, then lower into locks.
- 'Vehicle reversing' alarm should sound until the tailgate engages locks when it should silence.



2748-DS005-OL1-D-GB-G2

- 80. If the vehicle is fitted with a waste container lifting device carry out the daily safety checks described in '3.2 Daily safety checks - waste container lifting device (when fitted)' on page 3-22.
- 81. If the vehicle is fitted with footboards carry out the daily safety checks described in '3.3 Daily safety checks - footboard (when fitted)' on page 3-24.
- 82. Check level of oil in hydraulic oil tank and top up if required (see '4.1 To check hydraulic system oil level' on page 4-3).

3.2 Daily safety checks - waste container lifting device (when fitted)



Caution
If one or more footboards is fitted, lower footboard(s) before operating waste container lifting device.

The following daily safety checks must be carried out on the waste container lifting device mechanism, in addition to checks specified in the chassis manufacturer's service information and section 3.1 Daily safety checks - refuse collection body before the vehicle commences service.

The following checks assume that the aforementioned daily safety checks have been carried out, the engine is running and the refuse collection bodywork operating system is in the 'Body system run mode' with the compaction mechanism and lifting device controls energised.

1. If the vehicle is fitted with foot boards, lower them.
2. If waste container lifting device is fitted with DIN arms, open the DIN arms.
 - Check that they open freely and are not seized.
 - Check that springs hold DIN arms in open position.
 - Check that the lock plates in the hooks move freely and are not seized.

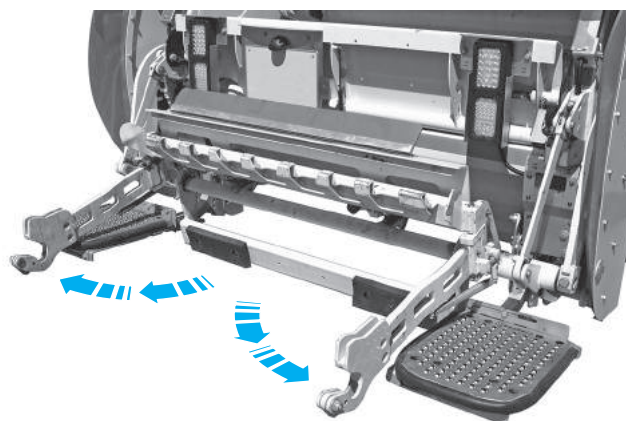

4614-OM1-R-GB-G1



WARNING:
KEEP CLEAR OF THE MOVING MECHANISM.



3. Operate the 'Lifting device up' push-button.



- Check that the lifting device rises.
- Check that the lip clamp closes when the mechanism passes 30° (1).
- Check that the lock plates in the DIN arm hooks close (2) as the lifting device rises.

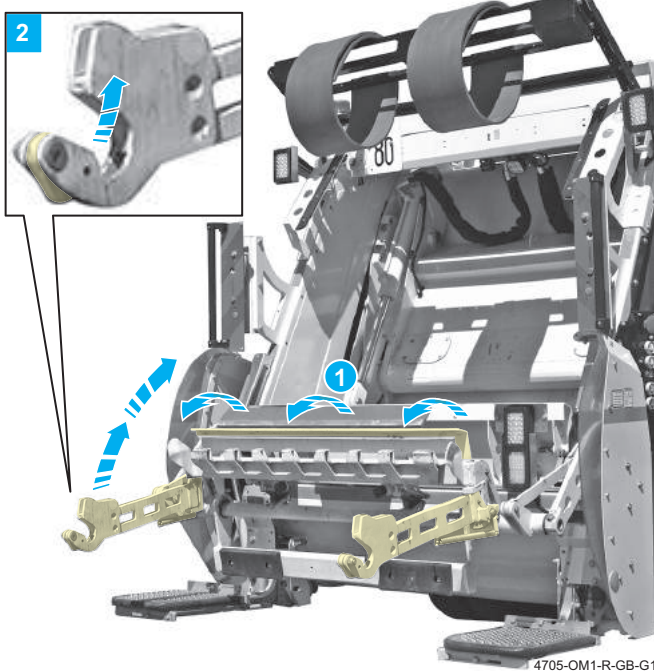

4. While the lifting device is rising release the push-button.
 - Check that the lifting device mechanism stops immediately and remains in the stopped position.
5. Operate the 'Lifting device up' push-button until the lifting device reaches full height.
6. Operate the 'Lifting device down' push-button.

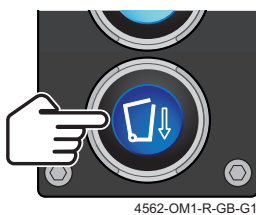

- Check that the lifting device lowers.

7. While the lifting device is lowering release the push-button.

- Check that the lifting device mechanism stops immediately and remains in the stopped position.

8. Operate the 'Lifting device down' push-button until the lifting device reaches fully down position.

- Check that the lip clamp opens when the mechanism passes 30° (3).
- Check that the lock plates in the DIN arm hooks open (4) as the lifting device lowers.

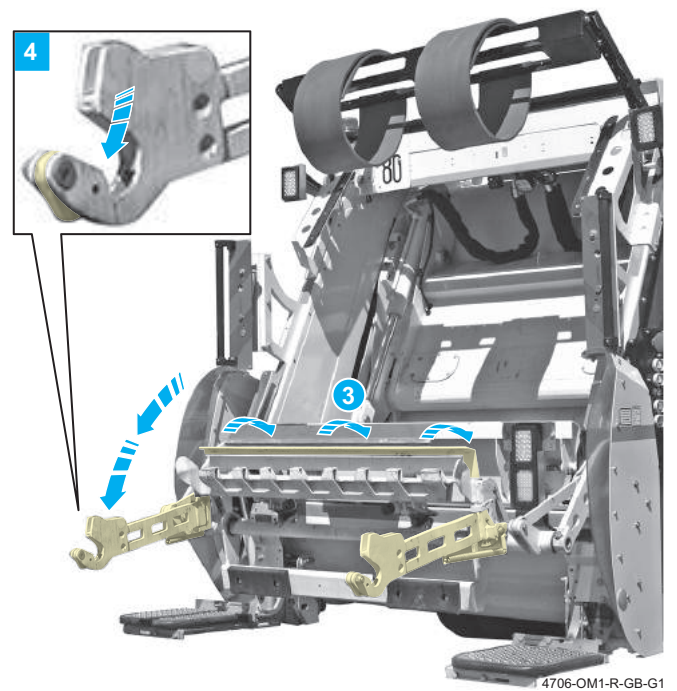

9. Stow DIN arms.

- Check that springs hold DIN arms in stowed position.



DAILY CHECKS

3.3 Daily safety checks - footboard (when fitted)

3

The following Daily safety checks must be carried out on each footboard, in addition to checks specified in the chassis manufacturer's service information and sections 3.1 Daily safety checks - refuse collection body and 3.2 Daily safety checks - waste container lifting device (when fitted) before the vehicle commences service.

The following checks assume that the aforementioned daily safety checks have been carried out, the engine is running and the refuse collection bodywork operating system is in the 'Body system run mode' with the compaction mechanism and lifting device controls energised.

1. Check the structural integrity of the footboard and handrail.
2. Check that the hydraulic strut holds the footboard in its raised and lowered positions.
3. Make sure that the visible faces of the footboard sensors and footboard stowed sensors (if fitted) are clean.



WARNING:
EXPLAIN TO OPERATIVE WHO WILL BE STANDING ON THE FOOTBOARD THE TESTS YOU WILL CONDUCT WHILE HE/SHE IS STANDING ON THE FOOTBOARD. AGREE ON SIGNALS YOU AND THE OPERATIVE WILL USE DURING THE TEST.

4. Arrange for an operative to stand on each footboard in turn and check that:
 - the 'Footboard occupied' pictogram (1) displays on the cab control panel screen.



- the compaction mechanism does not operate (Open system vehicles).
- the waste container lifting device mechanism does not operate.



WARNING:
TAKE EXTREME CARE. CARRY OUT FOLLOWING TEST ON TRAFFIC FREE ROAD.

With the operative still standing on the footboard, drive the vehicle forwards and steadily accelerate the vehicle. Check that the vehicle speed limiter engages and prevents vehicle exceeding 30 km/h.



WARNING:
TAKE EXTREME CARE. CARRY OUT FOLLOWING TEST ON TRAFFIC FREE ROAD.

5. Stop the vehicle. With the operative still standing on the footboard and the engine running, select reverse gear and check that one of the following occurs dependant on market:
 - reverse gear does not engage (vehicles fitted with autobrake function).

or

 - the brakes apply (vehicles fitted with autobrake function).

or

 - the engine shuts down (vehicles not fitted with autobrake function).
6. Apply the parking brake.
7. Ask operative to dismount from the footboard.
8. Select neutral.
9. Operate the 'Footboard interlock override switch' and check that:
 - the 'Footboard interlock override switch operated' pictogram displays on the screen.

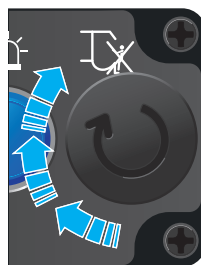

- the warning buzzer sounds.
- the refuse collection body compaction and discharge mechanisms do not operate.
- the waste container lifting device mechanism does not operate.



10. Select reverse gear and check that one of the following occurs dependant on market:
 - reverse gear engages (vehicles fitted with autobrake function).or
 - the brakes release (vehicles fitted with autobrake function).or
 - the engine can be started (vehicles not fitted with autobrake function).
11. Reset the 'Footboard interlock override switch', making sure that the safety lock has reset, and check that:
 - the 'Footboard interlock override switch delay timer' pictogram displays on the screen for a delay period of at least 5 minutes.
 - the refuse collection vehicle compaction and discharge mechanisms do not operate while the 'Footboard interlock override switch delay timer' pictogram is displayed and operates when it has extinguished.
 - the waste container lifting device mechanism does not operate while the 'Footboard interlock override switch delay timer' pictogram is displayed and operates when it has extinguished.



4707-OM1-R-GB-G1

12. Stow each footboard.
13. Check that all footboard warning and advisory labels are present, complete, legible and clean (see '3.5 Warning labels' on page 3-28).
14. Report any fault to supervision.



DAILY CHECKS

3.4 Daily safety check - safety light curtain (when fitted)

3

If a safety light curtain is fitted, the following Daily safety checks must be carried out, in addition to checks specified in the chassis manufacturer's service information and sections 3.1 Daily safety checks - refuse collection body and 3.2 Daily safety checks - waste container lifting device (when fitted) before the vehicle commences service.

The following checks assume that the aforementioned daily safety checks have been carried out, the engine is running and the refuse collection bodywork operating system is switched off.



WARNING:
USE A SOFT TEST ROD TO TEST OPERATION OF SAFETY LIGHT CURTAIN. DO NOT USE YOUR HAND(S).

1. Check that the tailgate area is clear.
2. Check the status displays in the top of the transmitter screen (see Fig. 3-1, 1) and receiver screen (see Fig. 3-1, 2).

When the body main switch is turned off:

- LED's A, B, C & D should be off.
- 7-segment display E should be off.

3. Turn the body main switch on:
 - LED A should turn green.
 - LED B should be off.
 - LED C should turn green.
 - LED D should turn yellow.
 - 7-segment display E should show '8' (momentarily), then 'S' for approximately 1.5 seconds while the system runs a self test sequence after which it should show 1 to indicate normal operation.

If LED A is red, a fault has occurred. If this happens refer to the manufacturer's operating instructions.

If the 7-segment display E shows '1' flashing, the transmitter and receiver screens should be cleaned using a mild detergent.

If the 7-segment display E shows 'F' alternating with a number, a fault has occurred. If this happens refer to the manufacturer's operating instructions.

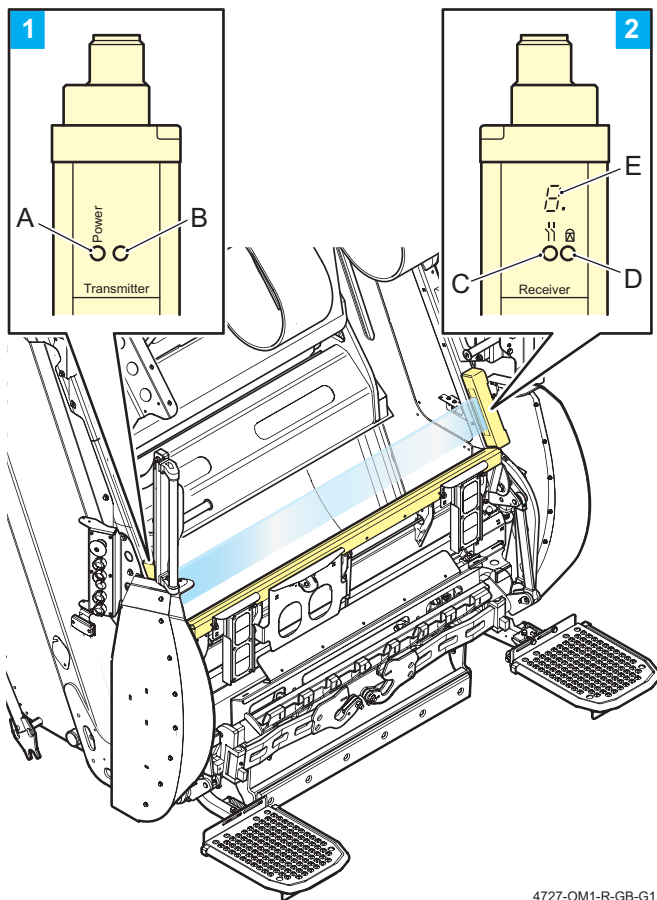

4727-OM1-R-GB-G1

Fig. 3-1 Safety light curtain status displays



4. Observe the status displays in the top of the transmitter and receiver screens and insert a suitable soft test rod (1) into the light curtain at point X and steadily move the test rod around the path indicated by the arrows (See Fig.3-2 Safety light curtain test path).
 - LED A should turn red immediately the test rod enters the safety curtain and not turn green again until the test rod is removed from the curtain.

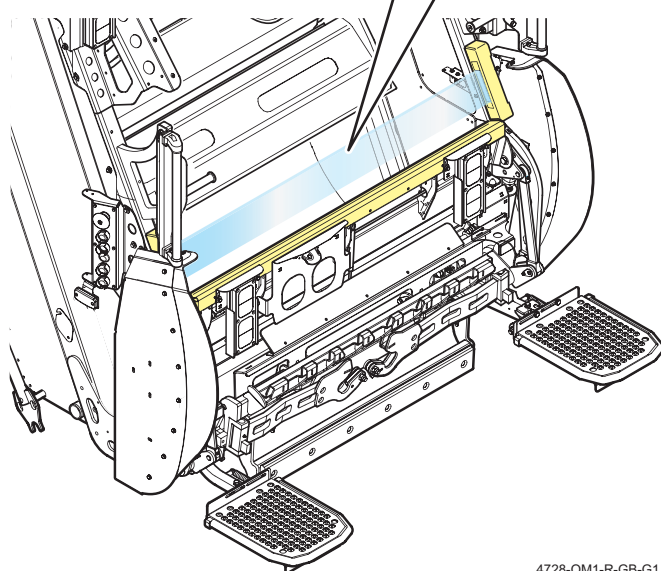
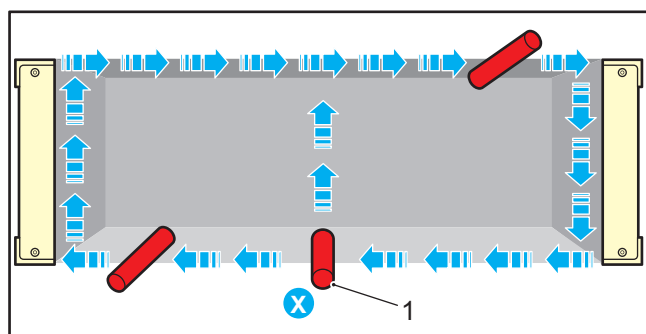

Fig. 3-2 Safety light curtain test path

5. Remove the soft test rod from the light curtain.

6. Press and release the 'Start pack cycle' push-button.



7. While the packer plate is closing and the carriage plate is moving upwards, place a suitable soft test rod into the light curtain.
 - The mechanism should continue to operate and complete the packing cycle.
8. Remove the soft test rod from the light curtain.
9. Press and release the 'Start pack cycle' push-button.



10. As the carriage plate is moving downwards, place a suitable soft test rod into the light curtain.
 - The compaction mechanism should stop immediately.
11. Remove the soft test rod from the light curtain.
 - The cycle should now complete automatically.



DAILY CHECKS

3.5 Warning labels

3

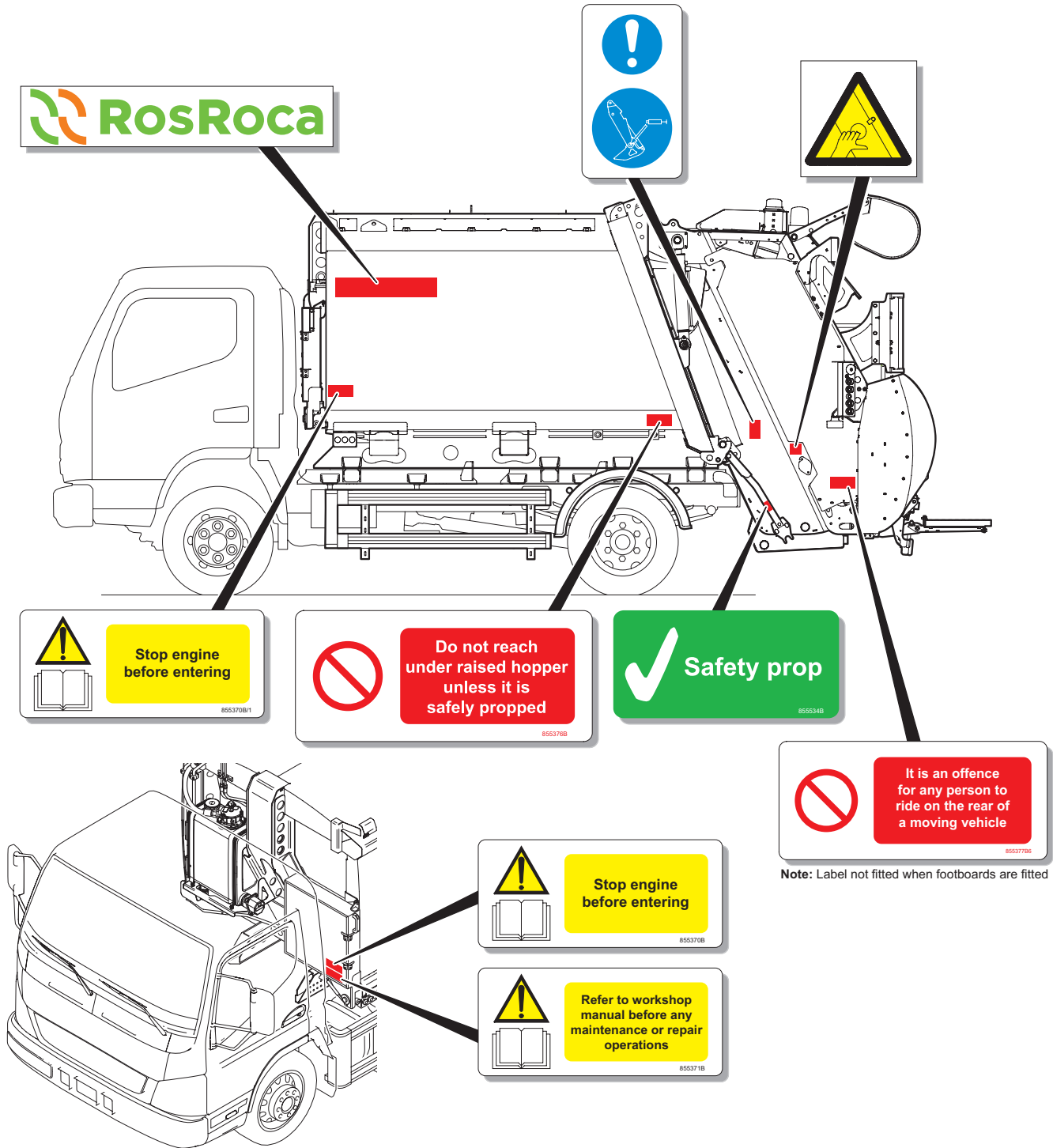

Fig. 3-3 Warning labels; left-hand side rear of refuse collection bodywork

4529-OM1-R-GB-G1

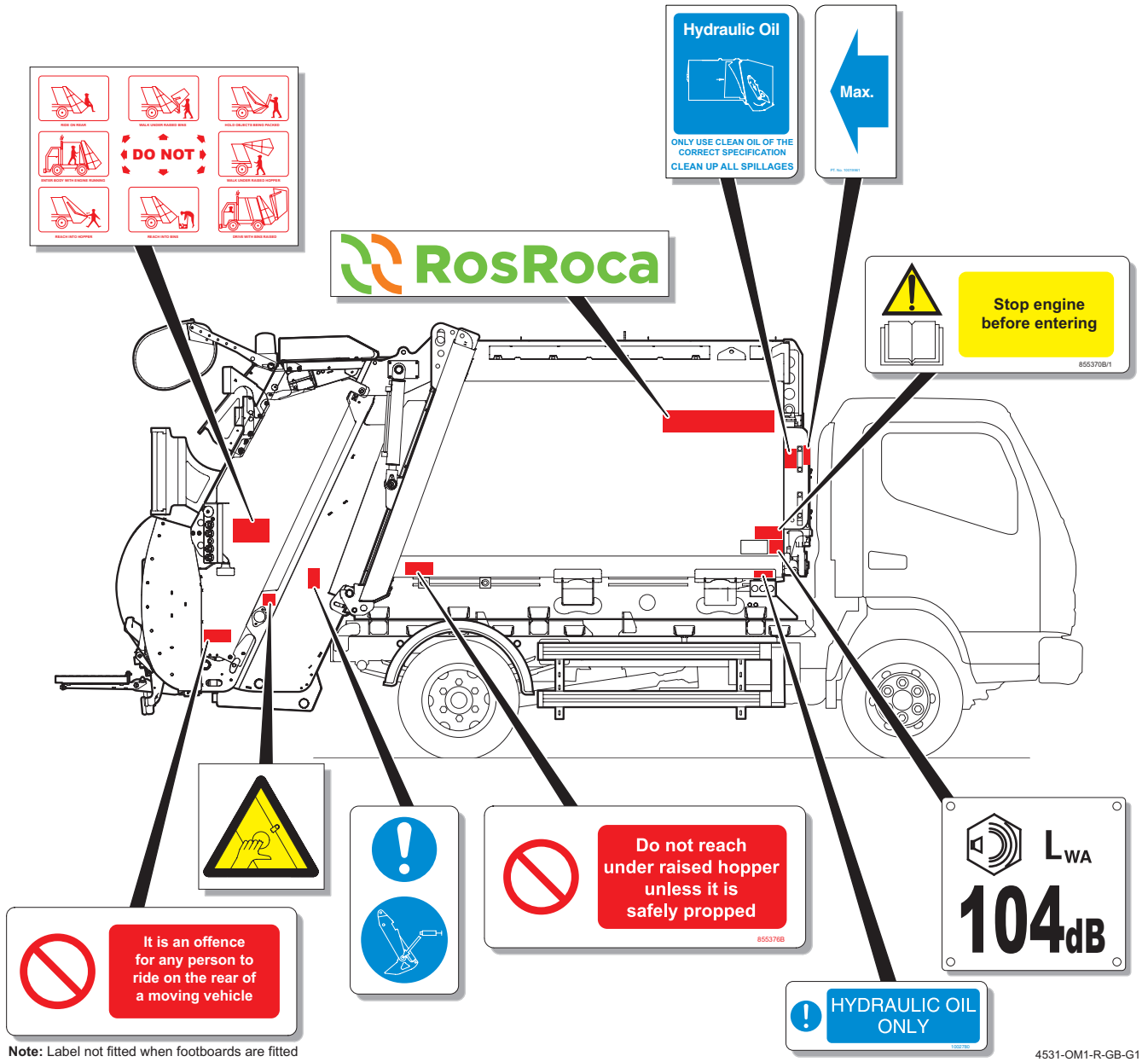

Fig. 3-4 Warning labels; right-hand side of refuse collection bodywork

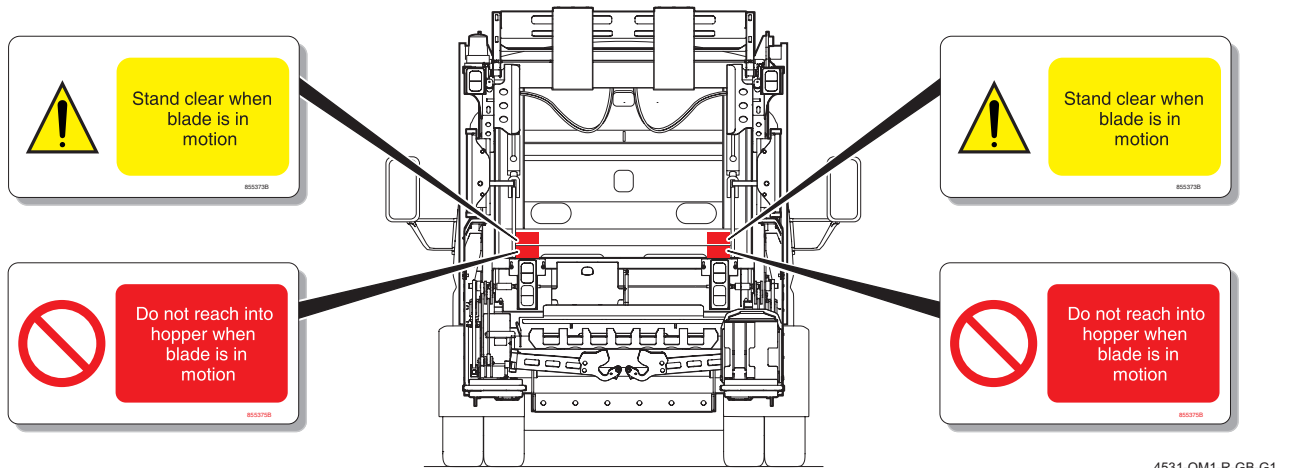

Fig. 3-5 Warning labels; rear of refuse collection bodywork



DAILY CHECKS

3.6 Explanation of pictorial warning labels

3

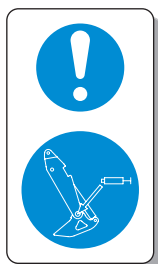

Lubrication point.



Do not put fingers into hole.



Maximum A-weighted sound pressure level at operator's workstations.